



# SIENNA

2 0 1 0

## QUICK REFERENCE GUIDE

# 2010 Sienna

This *Quick Reference Guide* is a summary of basic vehicle operations. It contains brief descriptions of fundamental operations so you can locate and use the vehicle's main equipment quickly and easily.

The *Quick Reference Guide* is not intended as a substitute for the *Owner's Manual* located in the vehicle's glove box. We strongly encourage you to review the *Owner's Manual* and supplementary manuals so you will have a better understanding of the vehicle's capabilities and limitations.

Your dealership and the entire staff of Toyota Motor Sales, U.S.A., Inc. wish you many years of satisfied driving in your new Sienna.

## ! A word about safe vehicle operations

This *Quick Reference Guide* is not a full description of Sienna operations. Every Sienna owner should review the *Owner's Manual* that accompanies this vehicle.

Pay special attention to the boxed information highlighted in color throughout the *Owner's Manual*. Each box contains safe operating instructions to help you avoid injury or equipment malfunction.

All information in this *Quick Reference Guide* is current at the time of printing. Toyota reserves the right to make changes at any time without notice.

## INDEX

### OVERVIEW

Engine maintenance	7
Fuel tank door release and cap	7
Hood release	6
Indicator symbols	4-5
Instrument cluster	4
Instrument panel	2-3
<b>Keyless entry<sup>1</sup></b>	<b>6</b>

### FEATURES/OPERATIONS

Air Conditioning/Heating	22-23
Audio	20-21
<b>Auto lock functions<sup>2</sup></b>	<b>8</b>
Automatic Transmission	8
Bottle holders	25
Clock	13
Console box	13
Cruise control	18
Cup holders	26
Door-Power back	12
Doors-Sliding	12
Dynamic Laser Cruise Control	18-19
Front seat console table	13
Light control-Instrument panel	19
<b>Lights<sup>1</sup> &amp; turn signals</b>	<b>9</b>
Moonroof	11
Multi-information display (HomeLink <sup>®</sup> ) <sup>3</sup>	24
Parking brake	10
Power outlets-12V DC	25
Power outlets-115V AC	25
Rear seat entertainment system	24
Seat adjustments-Front	14
Seat adjustments-Rear	14
Seat arrangements	15
Seat heaters	11
Seats-Head restraints	15
Seats-Stowing third row seats	16-17
Seats-Tumble/Remove second row seats	16
Sunshade-Side	17
Telephone controls (Bluetooth <sup>®</sup> )	21
Tilt and telescopic steering wheel	8
Windows	11
Windows-Power quarter	10
Windshield wipers & washers	10

### SAFETY AND

### EMERGENCY FEATURES

Door locks	27
Doors-Child safety locks	27
Seatbelt comfort guide	27
Seatbelts	28
Seatbelts-Shoulder belt anchor	27
Spare tire & tools	29
Tire Pressure Monitoring (warning) System	28

<sup>1</sup> Visit your Toyota dealer for information on customizing this feature.

<sup>2</sup> Programmable by customer. Refer to the *Owner's Manual* for instructions and more information.

<sup>3</sup> HomeLink<sup>®</sup> is a registered trademark of Johnson Controls, Inc.

# OVERVIEW

## Instrument panel

### Overhead console

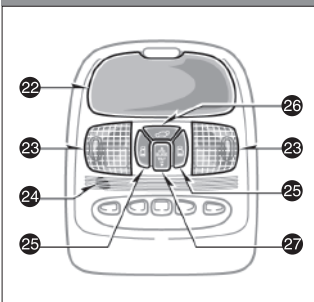

### Steering wheel switches

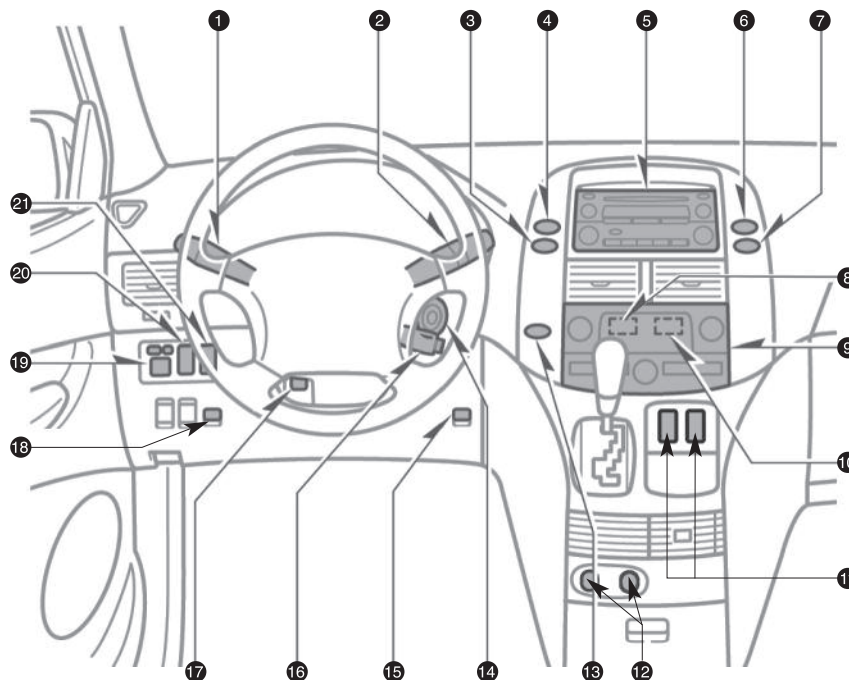
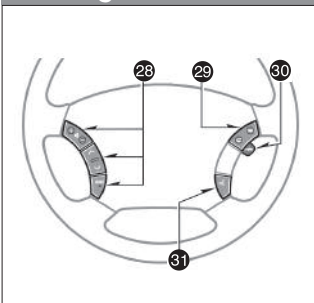

- 1 Headlight, turn signal and front fog light<sup>1</sup> controls
- 2 Wiper and washer controls
- 3 Rear window and outside rearview mirror defogger<sup>1</sup> and windshield wiper de-icer<sup>1</sup> switch
- 4 Emergency flasher button
- 5 Audio system or navigation system<sup>2</sup>
- 6 115V AC Power outlet ON/OFF button<sup>1</sup>
- 7 AUX adapter
- 8 Intuitive parking assist switch and indicator<sup>1</sup>
- 9 Front Air Conditioning controls
- 10 Front passenger occupant classification indicator
- 11 Seat heater switches<sup>1</sup>
- 12 12V DC Power outlets
- 13 Interior lights main switch
- 14 Ignition switch
- 15 "TRAC OFF" (Traction Control "OFF")<sup>1</sup>
- 16 Cruise control or Dynamic Laser Cruise Control<sup>1</sup>

- 17 Tilt and telescopic steering lock release
- 18 Tire Pressure Monitoring (warning) System reset
- 19 Power rearview mirror controls
- 20 Power quarter window switch<sup>1</sup>
- 21 Headlight beam level control dial<sup>1</sup>
- 22 Conversation mirror
- 23 Front personal lights
- 24 Microphone<sup>1,2</sup>
- 25 Power sliding door button<sup>1</sup>
- 26 Power back door button<sup>1</sup>
- 27 Electric moonroof switch<sup>1</sup>
- 28 Steering wheel audio controls<sup>1,2</sup>
- 29 Telephone controls<sup>1,2</sup>
- 30 Dynamic Laser Cruise Control distance switch<sup>1</sup>
- 31 Speech command button<sup>1,2</sup>

<sup>1</sup> If equipped

<sup>2</sup> For vehicles with a navigation system, refer to the "Navigation System Owner's Manual."

### Instrument cluster

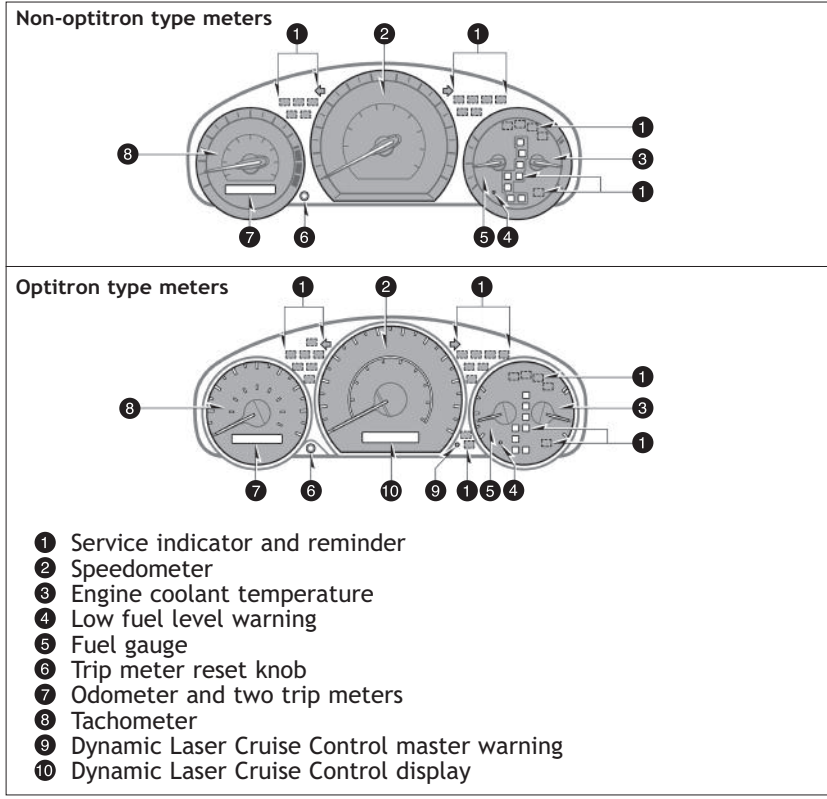

### Indicator symbols

For details, refer to “Indicators and warning lights,” Section 2-2, 2010 Owner’s Manual.

- BRAKE** Brake system warning<sup>1,2</sup>
- Driver seatbelt reminder<sup>2</sup> (alarm will sound if speed is over 12 mph)
- Front passenger seatbelt reminder<sup>2</sup> (alarm will sound if speed is over 12 mph)
- Charging system warning<sup>1,2</sup>
- Malfunction/Check Engine indicator<sup>1,2</sup>

- Low engine oil pressure warning<sup>1,2</sup>
- Open door warning<sup>2</sup>
- Airbag SRS warning<sup>1,2</sup>
- VSC** Vehicle Stability Control/Traction Control warning<sup>1,2</sup>
- Low Tire Pressure Warning<sup>1,2</sup>
- Low windshield washer fluid level warning<sup>2</sup>
- MAINT REQD** Engine oil replacement reminder<sup>1,2</sup>
- 3RD SEAT** Third seat fold incomplete warning<sup>2</sup>
- Theft deterrent/Engine immobilizer system indicator
- AIR BAG ON** AIR BAG ON indicator<sup>1</sup>
- AIR BAG OFF** AIR BAG OFF indicator<sup>1</sup>
- Headlight low beam indicator
- Headlight high beam indicator
- Turn signal indicator
- Automatic Transmission indicator
- Slip indicator<sup>1</sup>
- TRAC OFF** Traction Control OFF indicator<sup>1</sup>
- CRUISE** Cruise control indicator<sup>3</sup> or Dynamic Laser Cruise Control indicator<sup>4</sup>
- READY** Dynamic Laser Cruise Control ready mode indicator<sup>1</sup>
- NORM.** Conventional cruise control mode indicator
- ABS** Anti-lock Brake System warning<sup>1,2</sup>

<sup>1</sup> If indicator does not turn off within a few seconds of starting engine, there may be a malfunction. Have vehicle inspected by your Toyota dealer.

<sup>2</sup> For details, refer to “If a warning light turns on or a warning buzzer sounds...,” Section 5-2, 2010 Owner’s Manual.

<sup>3</sup> If this light flashes, refer to “Cruise control,” Section 2-4, 2010 Owner’s Manual.

<sup>4</sup> If this light flashes, refer to “Dynamic laser cruise control,” Section 2-4, 2010 Owner’s Manual.

### Keyless entry

#### Locking operation

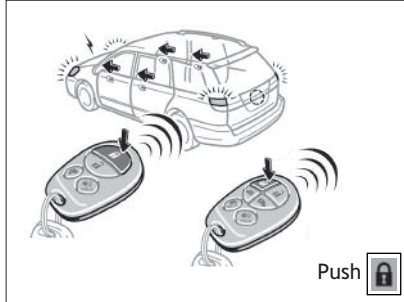

#### Unlocking operation

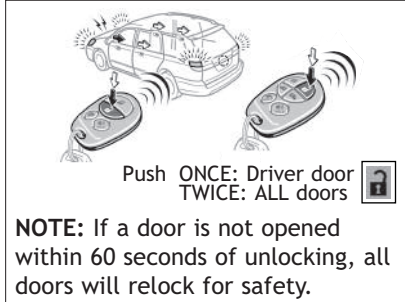

#### Power sliding door operation (if equipped)

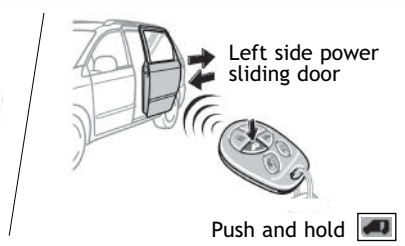
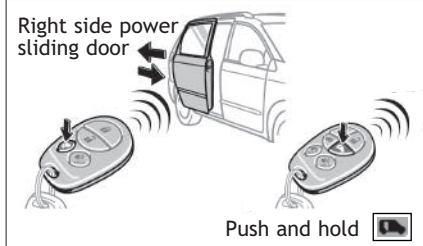

#### Power back door operation (if equipped)



#### Panic button



### Hood release

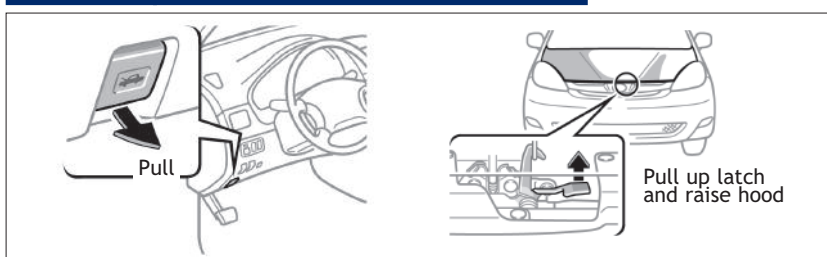

### Fuel tank door release and cap

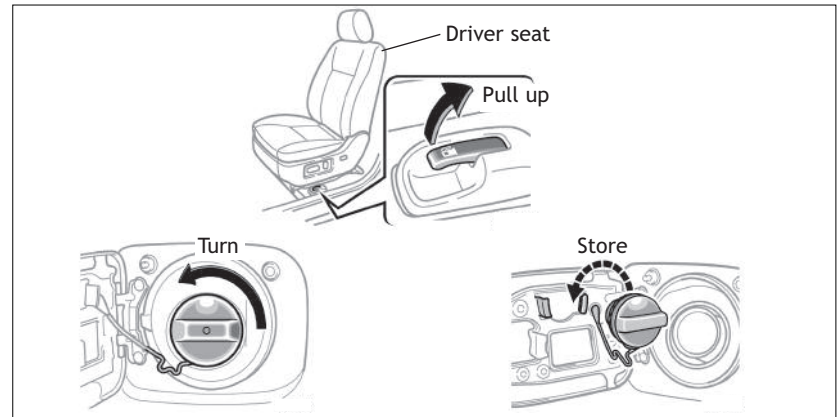

**NOTE:** Tighten until one click is heard. If the cap is not tightened enough, Check Engine “” indicator may illuminate.

### Engine maintenance

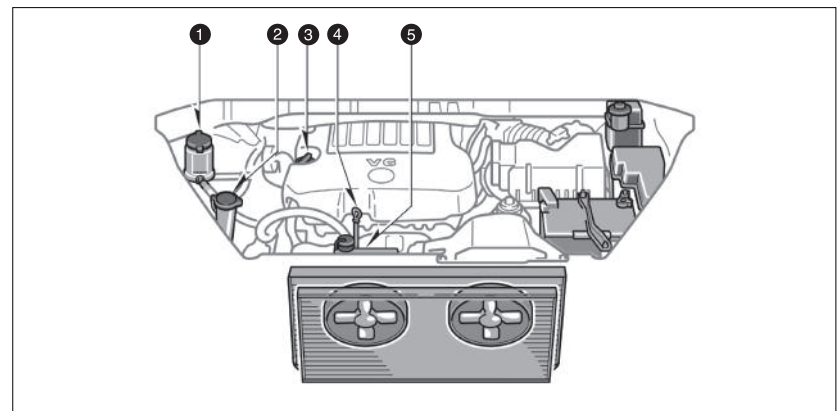

- ① Power steering fluid reservoir
- ② Windshield and rear window washer fluid tank
- ③ Engine oil filler cap
- ④ Engine oil level dipstick
- ⑤ Engine coolant reservoir

**Note:** Regularly scheduled maintenance, including oil changes, will help extend the life of your vehicle and maintain performance. Please refer to the “Warranty Maintenance Guide.”

# FEATURES/OPERATIONS

## Auto lock functions

Automatic door locks can be programmed to operate in four different modes, or turned OFF.

- Doors lock when shifting from Park.
- Doors lock when the vehicle speed goes above approximately 12 mph.
- Doors unlock when the engine key is turned to the "ACC" or "LOCK" position and driver's door is opened.
- Doors unlock when shifting into Park.

## Automatic Transmission

- |          |             |
|----------|-------------|
| <b>P</b> | Park*       |
| <b>R</b> | Reverse     |
| <b>N</b> | Neutral     |
| <b>D</b> | Drive       |
| <b>4</b> | Fourth gear |
| <b>3</b> | Third gear  |
| <b>2</b> | Second gear |
| <b>L</b> | First gear  |

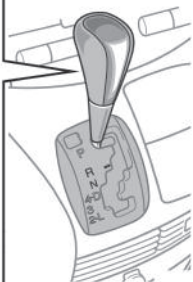

\* The engine switch must be "ON" and the brake pedal depressed to shift from Park.

Downshifting increases power going uphill, or provides engine braking downhill. For best fuel economy during normal driving conditions, always drive with the shift lever in the "D" position.

## Tilt and telescopic steering wheel



Hold wheel, push lever down, set angle and length, and return lever.

**Note:** Do not attempt to adjust while the vehicle is in motion.

## Lights & turn signals

### Headlights

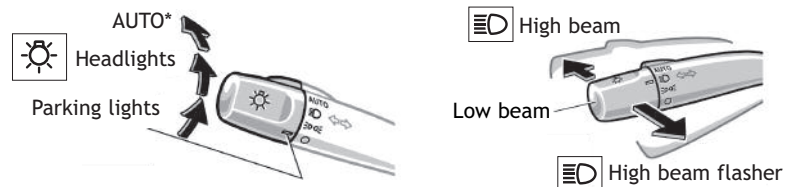

\* If equipped

-**Daytime Running Light system (if equipped)** Automatically turns on the headlights at a reduced intensity.

-**Automatic light cut off system** Automatically turns lights off after 30 seconds when any of the doors are opened and closed with the engine off. Lights may also be turned off by pushing lock button on remote once more after locking.

### Turn signals

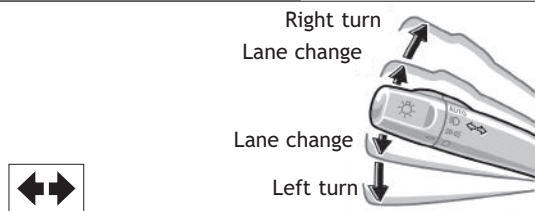

### Front fog lights (if equipped)

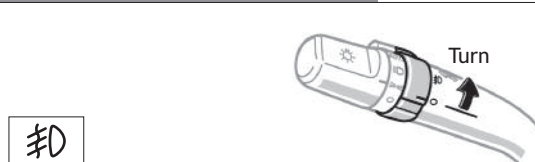

Front fog lights come on only when the headlights are on low beam.

### Headlight beam level control (if equipped)

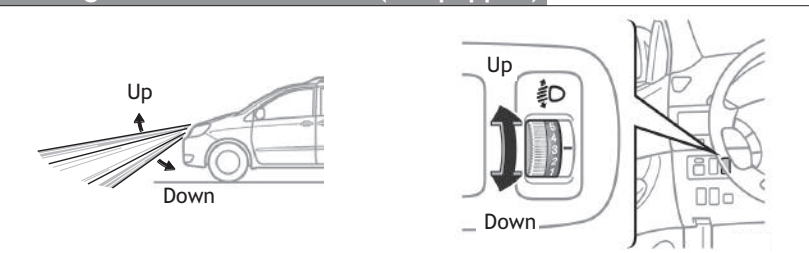

Higher number will lower the beam.

## Windshield wipers & washers

### Front

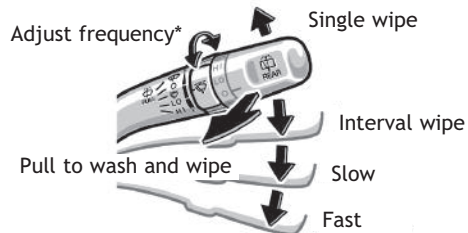

**\* Intermittent windshield wiper frequency adjustment**  
Rotate to increase/decrease wipe frequency.

### Rear

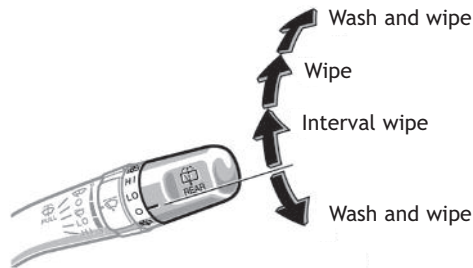

## Parking brake

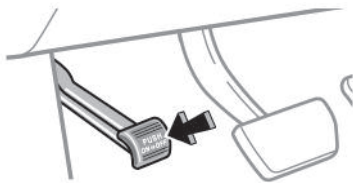

**BRAKE**

Set: Depress  
Release: Depress again

## Windows-Power quarter (if equipped)

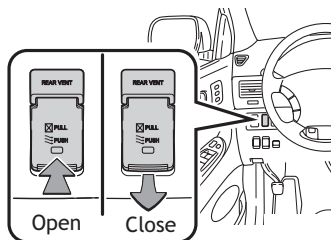

## Windows

### Driver side

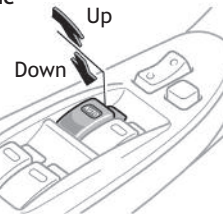

### Window lock switch

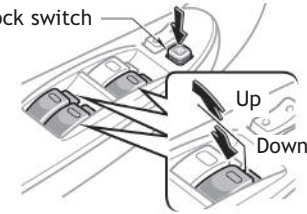

**Automatic operation (driver side only)** (If equipped) Push the switch completely down or pull it completely up and release to fully open or close. To stop window midway, lightly push the switch in the opposite direction.

**Window lock switch** Deactivates all passenger windows. Driver's window remains operable.

**NOTE:** If battery is disconnected, the windows need to be reinitialized. Refer to the *Owner's Manual* for more details.

## Moonroof (if equipped)

### Sliding operation

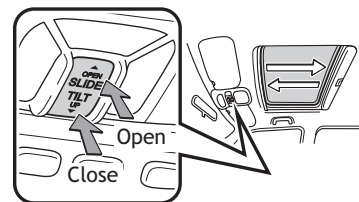

### Tilting operation

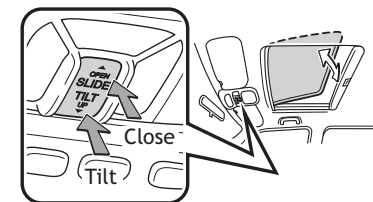

**NOTE:** If battery is disconnected, the moonroof needs to be reinitialized. Refer to the *Owner's Manual* for more details.

## Seat heaters (if equipped)

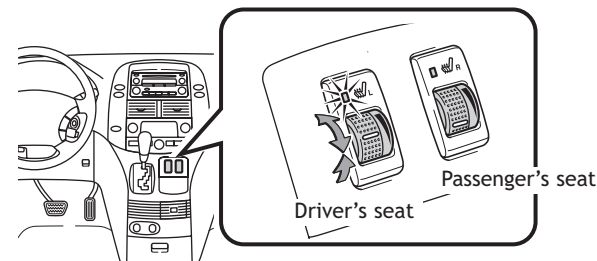

### Doors-Sliding

#### ON/OFF switch

Instrument panel

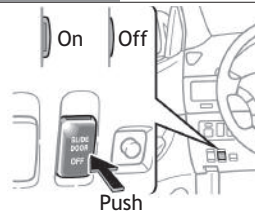

#### Opening/Closing

Front overhead console

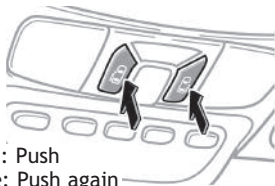

Open: Push  
Close: Push again

Center pillar

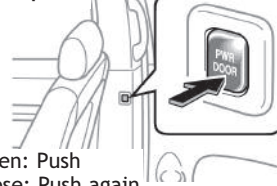

Open: Push  
Close: Push again

#### Power

- Sliding doors will not fully open if the sliding door window is open.
- When the engine switch is in the “ON” position, power sliding doors will open only when gear selector is in the “P” (Park) position, and doors are unlocked. Refer to the *Owner’s Manual* for more details.
- An alarm will sound if a sliding door is open and the vehicle is shifted out of Park.
- If battery is disconnected, the power sliding doors need to be reinitialized. Refer to the *Owner’s Manual* for more details.

#### Manual

- Sliding doors will not lock into the open position if the sliding door window is open.

### Door-Power back (if equipped)

#### ON/OFF switch

Instrument panel

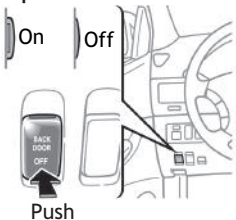

#### Opening/Closing

Front overhead console

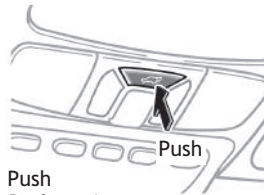

Open: Push  
Close: Push again

**NOTE:** If battery is disconnected, the power back door needs to be reinitialized. Refer to the *Owner’s Manual* for more details.

### Console box (if equipped)

#### Remove

1

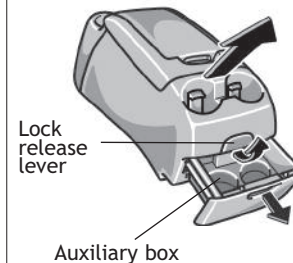

#### Install

2

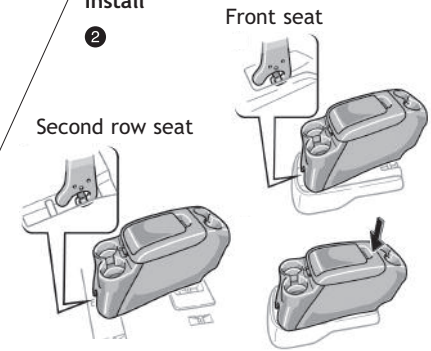

The console box can be removed and installed between the front or second row seats.

- 1 **To remove** Open the auxiliary box on the rear side, and pull the lock release lever. Lift the box from the rear to release it from the hook.
- 2 **To install** Place the hook into the striker. Lower box and push down to engage the rear lock.

### Front seat console table (if equipped)

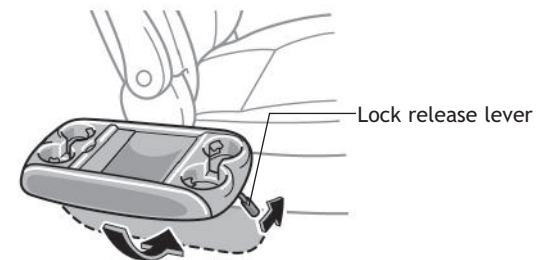

### Clock

With manual  
Air Conditioning system

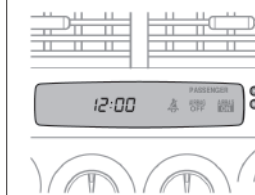

With automatic  
Air Conditioning system

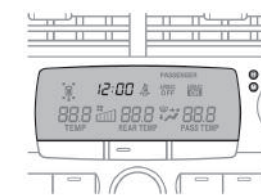

H- Hour set  
M- Minute set



### Seat adjustments-Front

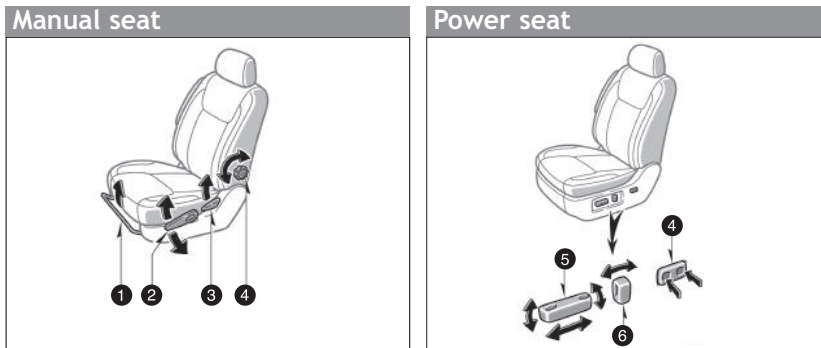

- 1 Seat position (forward/backward)
- 2 Height crank (driver side only)
- 3 Seatback angle
- 4 Lumbar support (driver side only)(If equipped)
- 5 Seat position, cushion angle and height
- 6 Seatback angle

### Seat adjustments-Rear

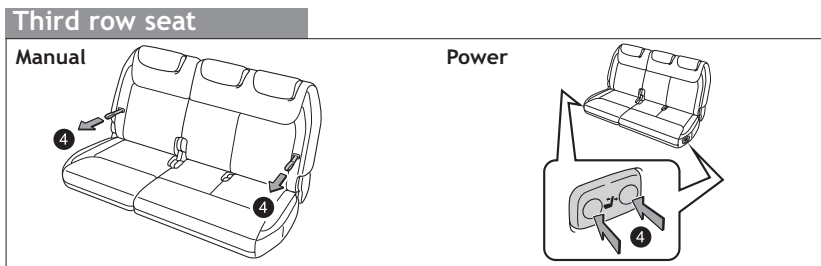
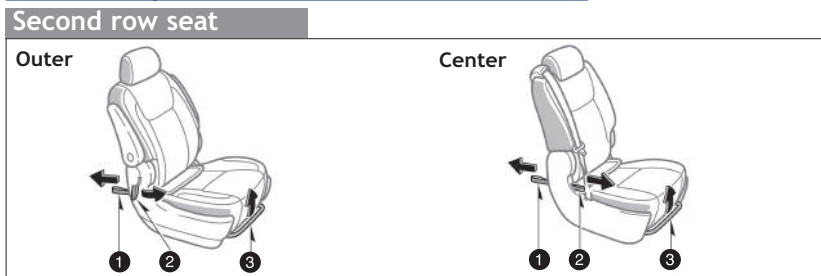

- 1 Seatback release (from third row seat)
- 2 Seatback release (from second row seat)
- 3 Seat position (forward/backward)
- 4 Seatback angle

Refer to the *Owner's Manual* for more details.

### Seats-Head restraints

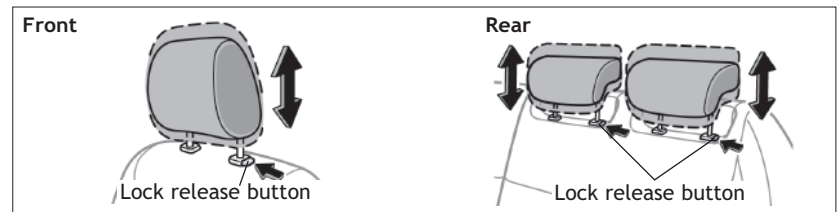

### Seat arrangements (examples)

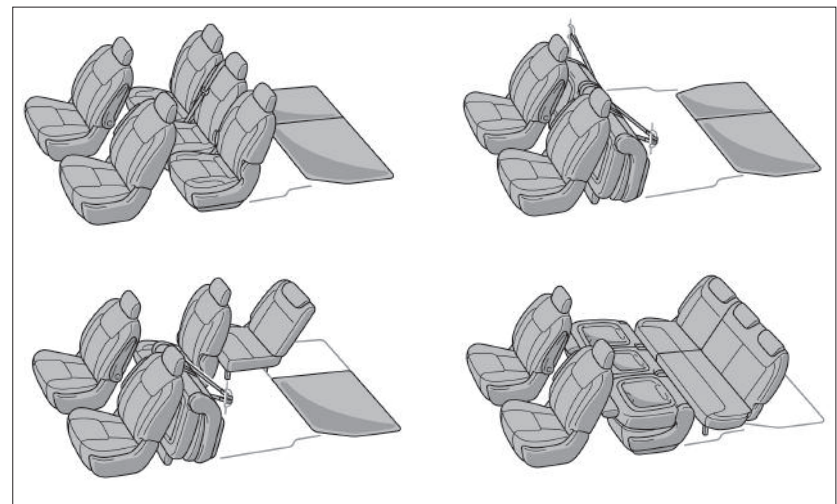

These are some possible seat arrangements. Please read the following section and refer to the *Owner's Manual* for more information about seat positions.

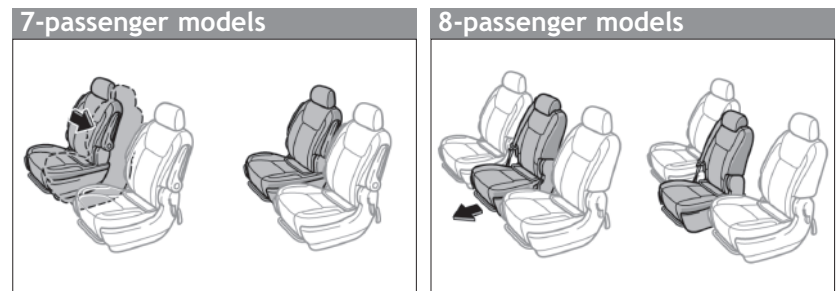

**7-passenger models** The right seat can be placed in the inside or outboard position.

**8-passenger models** The center seat can be placed in the forward position or even with the other seats.

**Seats-Tumble/Remove second row seats**

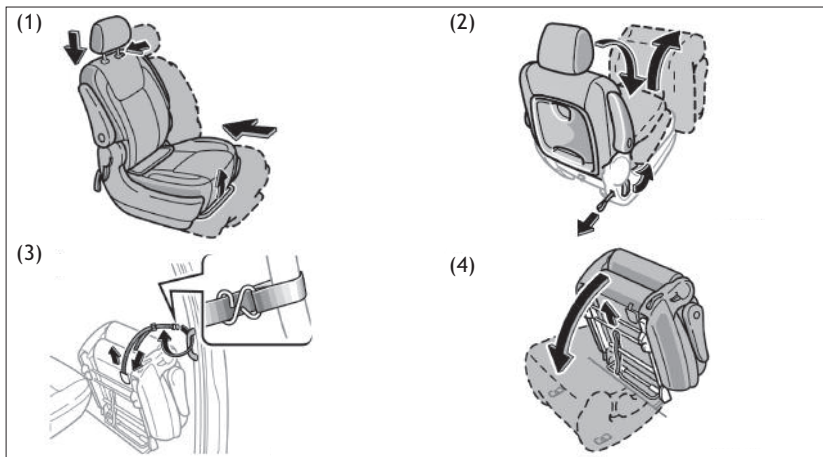

- (1) Lower the head restraint and slide the seat to the rear-most locked position.
- (2) Pull the strap or lever and tumble the seat.
- (3) Pass the strap through the assist grip.
- (4) Pull and hold the strap, then fold down the seat to disengage from front hooks.

**Seats-Stowing third row seats (manual)**

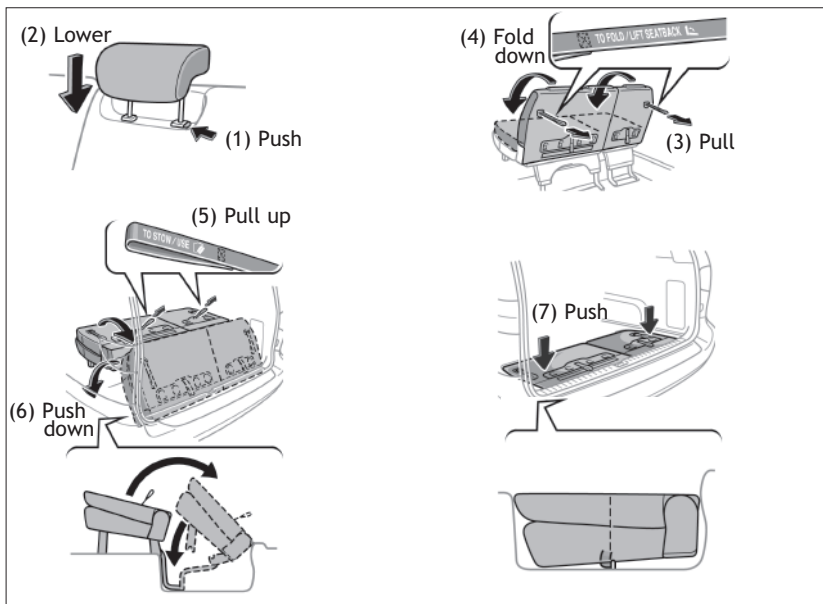

**Seats-Stowing third row seats (power)(if equipped)**

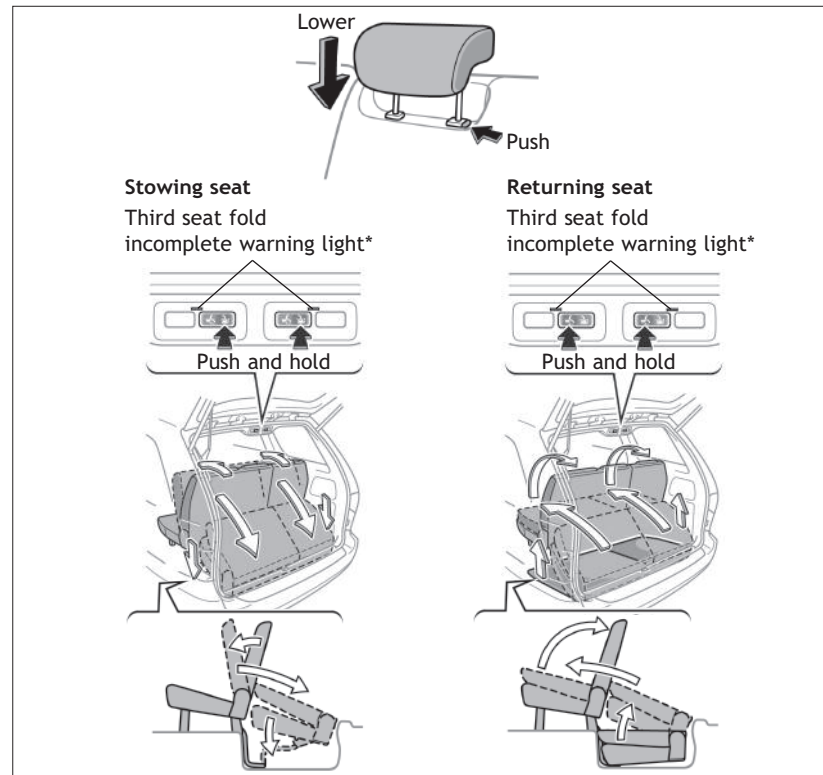

\* This light will remain ON until the seat is fully open or stowed.

An alarm will also sound for 10 seconds, and the **3RD SEAT** indicator will light up on the instrument panel.

Refer to the *Owner's Manual* for more details.

**Sunshade-Side (if equipped)**

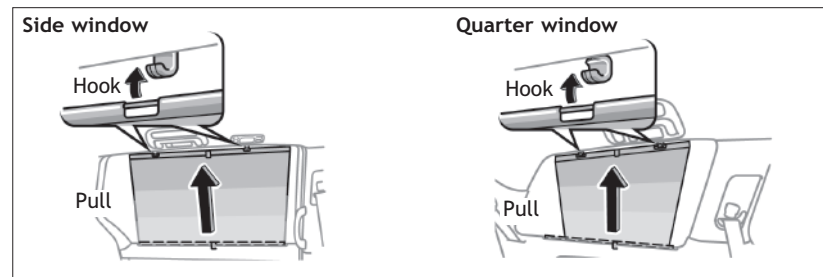

**Cruise control (if equipped)**

**Turning system ON/OFF**

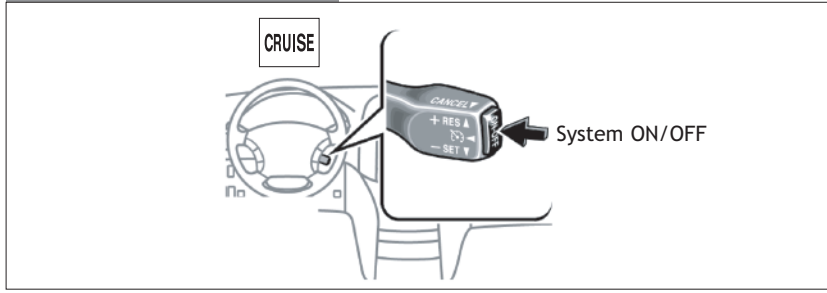

**Functions**

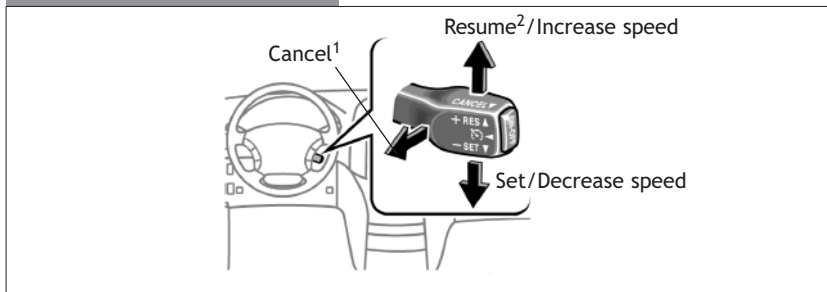

¹ The set speed may also be cancelled by depressing the brake pedal.  
 ² The set speed may be resumed once vehicle speed reaches 25 mph.

**Dynamic Laser Cruise Control (if equipped)**

Refer to the *Owner's Manual* for more details and complete safety precautions before attempting to use the "Dynamic Laser Cruise Control."

**Fixed speed mode**

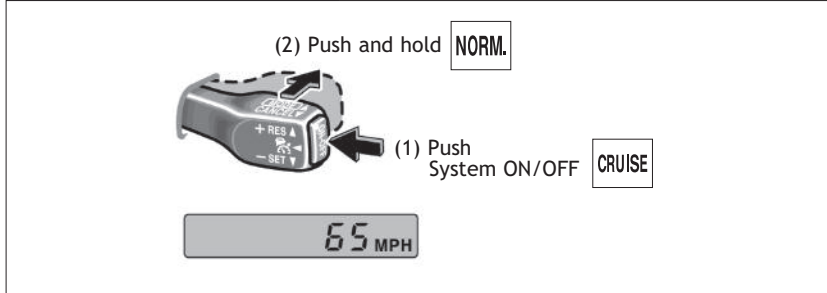

To set, cancel and resume a speed Refer to "Functions" in the *Cruise Control* section above, and to the *Owner's Manual* for more details.

**Distance control mode**

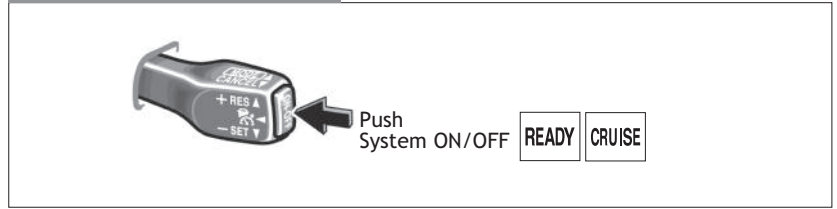

The distance control mode will cruise at a set speed, decelerate to maintain a selected distance from a slower vehicle traveling in front of you, and accelerate back up to the selected speed if the vehicle in front changes lanes or speeds up.

To set, cancel and resume a speed Refer to "Functions" in the *Cruise Control* section at left, and your *Owner's Manual* for more details.

**NOTE:** Once vehicle speed is set, pushing lever up toward "+ RES" will increase speed to the nearest 5 mph, and then in 5 mph increments. Pushing lever down toward "- SET" will reduce speed in the same way.

**Changing vehicle-to-vehicle distance**

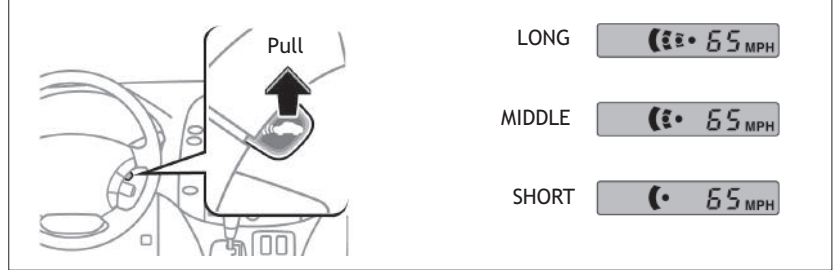

**Light control-Instrument panel**

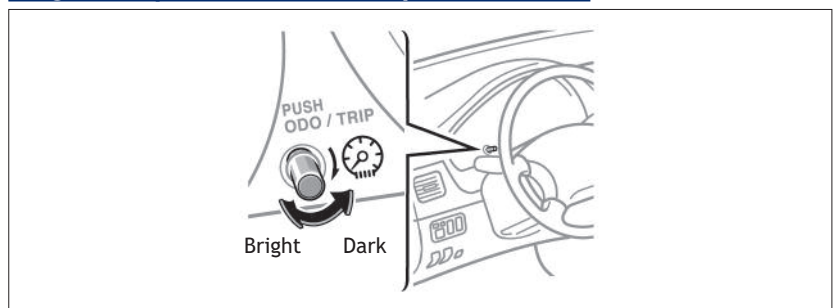

To set, cancel and resume a speed Refer to "Functions" in the *Cruise Control* section above, and to the *Owner's Manual* for more details.

Audio

Type 1

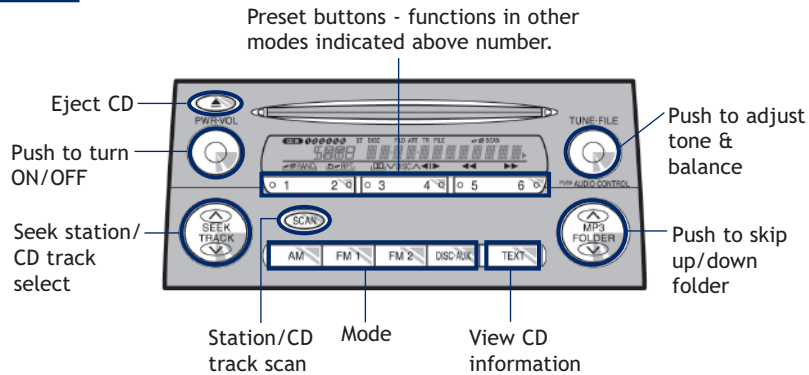

Type 2 additional functions

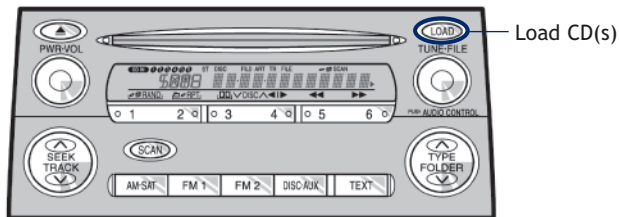

CD PLAYER

To scan tracks on a disc Push “SCAN.” Push again to hold selection.  
 CD Changer (Type 2 only)  
 -To load one disc Push “LOAD” and insert one disc.  
 -To load multiple discs Push and hold “LOAD” until you hear a beep. Insert one disc. Shutter will close and then re-open for next disc.  
 To select a file (MP3/WMA only) Turn “TUNE·FILE.”  
 To select a folder (MP3/WMA only) Push either side of “MP3/FOLDER.”

RADIO

To preset stations Tune in the desired station and hold down a preset button (1-6) until you hear a beep. Push desired preset button (1-6) to select.  
 To scan stations Push “SCAN.” Push and hold to scan preset stations. Push again to hold selection.

Steering wheel switches (if equipped)

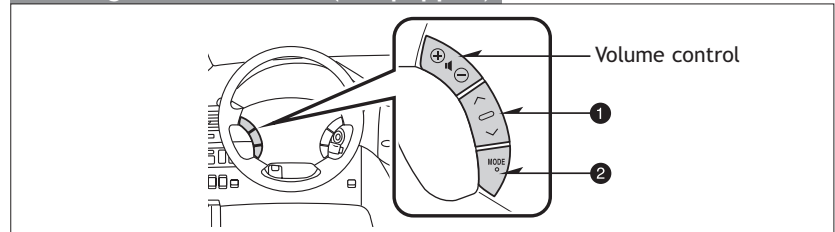

- 1 “^ v”  
 -In radio mode Push to select a preset station; push and hold to seek the next strong station.  
 -In CD mode Push to skip up or down to next/previous track.
- 2 “MODE”  
 Push to turn audio ON and select an audio mode. Push and hold to turn the audio system OFF.

AUX adapter

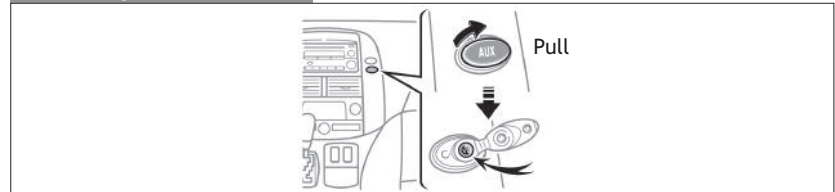

By inserting a mini plug into the AUX audio jack, you can listen to music from a portable audio device through the vehicle’s speaker system while in AUX mode.

Telephone controls (Bluetooth®) (if equipped)

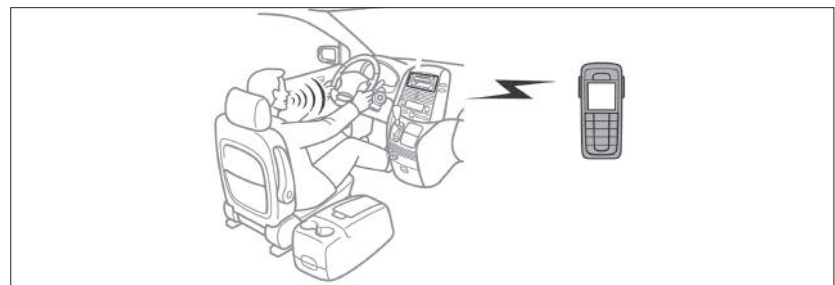

Bluetooth® technology allows dialing or receipt of calls without taking hands from the steering wheel or using a cable to connect the telephone and the system.

Refer to “Using the hands-free phone system (for cellular phone),” Section 3-4 in the *Owner’s Manual* for more details.

## Air Conditioning/Heating

### Front manual Air Conditioning

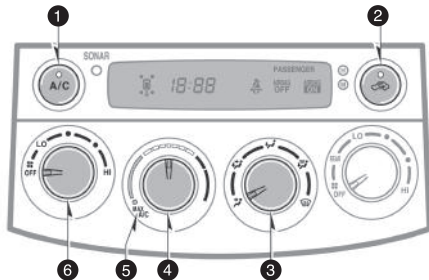

- ❶ Air Conditioning ON/OFF
- ❷ Fresh or recirculated cabin air
- ❸ Airflow vent
- In “” or “” mode, use fresh air (“” indicator OFF) to reduce window fogging.
- ❹ Temperature selector
- ❺ Use for quick cooling. MAX A/C changes air intake to recirculate. It is not possible to change intake to fresh.
- ❻ Fan speed

### Rear manual Air Conditioning

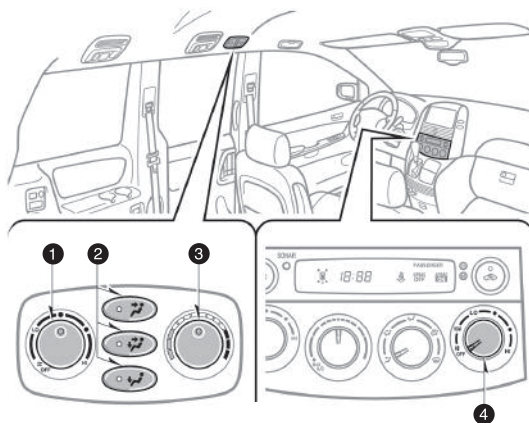

- ❶ Fan speed
- ❷ Airflow vent
- ❸ Temperature selector
- ❹ Fan speed

### Front automatic Air Conditioning

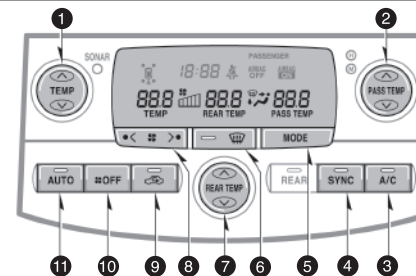

- ❶ Temperature selector (driver side)
- ❷ Temperature selector (front passenger side)
- ❸ Air Conditioning ON/OFF
- ❹ Synchronizes front and rear temperature settings
- ❺ Airflow vent
- In “” or “” mode, use fresh air (“” indicator OFF) to reduce window fogging.
- ❻ Windshield airflow/defogger
- ❼ Temperature selector (rear passenger side)
- ❽ Fan speed
- ❾ Fresh or recirculated cabin air
- ❿ Climate control OFF
- ⓫ Automatic climate control ON/OFF

### Rear automatic Air Conditioning

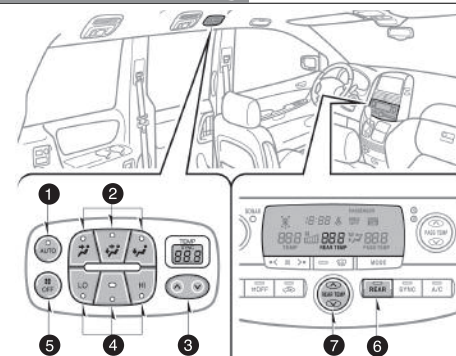

- ❶ Automatic climate control ON/OFF
- ❷ Airflow vent
- ❸ Temperature selector
- ❹ Fan speed
- ❺ Climate control OFF
- ❻ ON/OFF switch
- ❼ Temperature selector

### Rear seat entertainment system (if equipped)

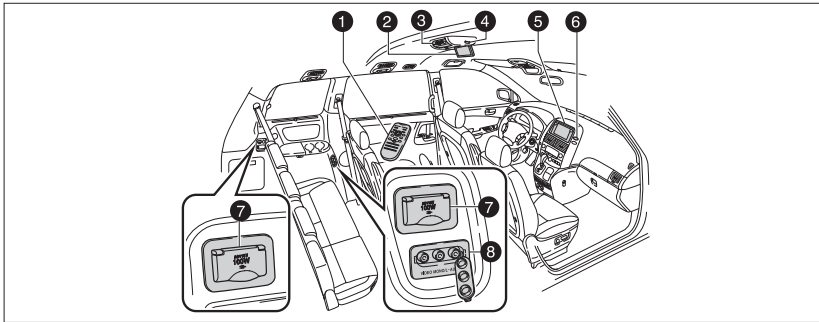

- ❶ Remote control
- ❷ DVD screen
- ❸ DVD player
- ❹ Headphone jacks and headphone volume control
- ❺ Front audio
- ❻ 115V AC Power outlet ON/OFF switch
- ❼ 115V AC Power outlets
- ❽ AV input adapter

### Multi-information display (HomeLink®)\* (if equipped)

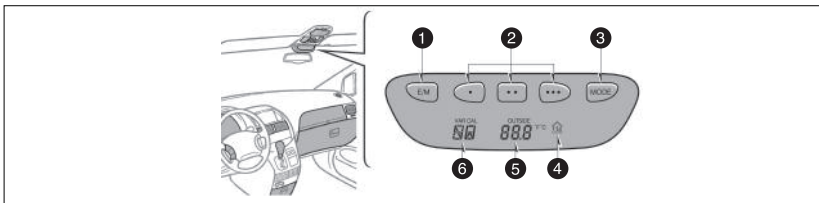

- ❶ Select standard or metric
- ❷ **Garage door opener buttons** Garage door openers manufactured under license from HomeLink®\* can be programmed to operate garage doors, estate gates, security lighting, etc.

Refer to “Garage door openers,” Section 3-7 in the *Owner’s Manual* for more details.

For programming assistance, contact the Toyota Customer Experience Center at 1-800-331-4331, or visit <http://www.homelink.com>.

- ❸ Change display information
- ❹ Garage door opener indicator
- ❺ Information display
- ❻ Compass

\* HomeLink® is a registered trademark of Johnson Controls, Inc.

### Power outlets-12V DC

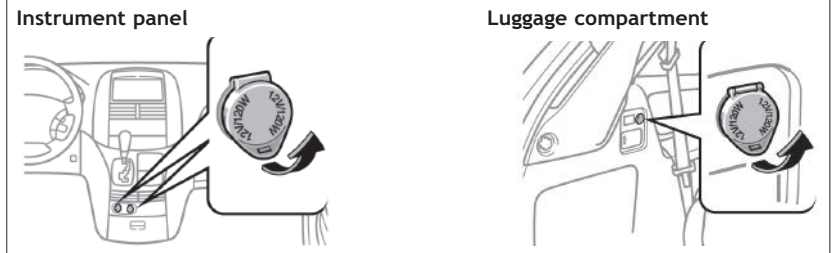

### Power outlets-115V AC (if equipped)

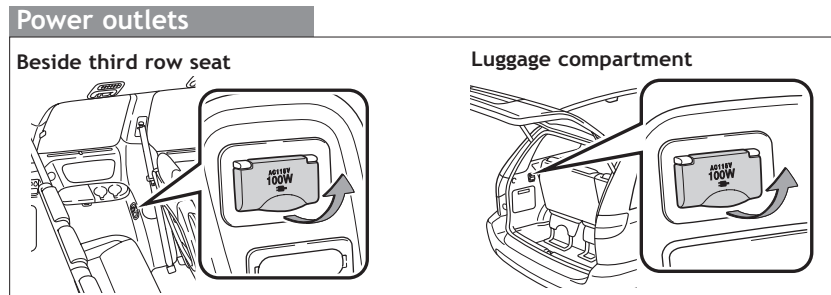
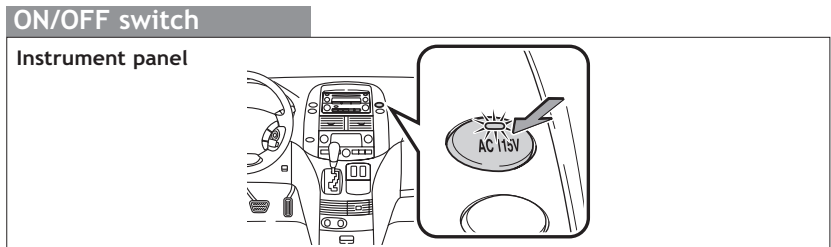

Designed for car accessories. Engine switch must be in the “ACC” or “ON” position to be used.

### Bottle holders

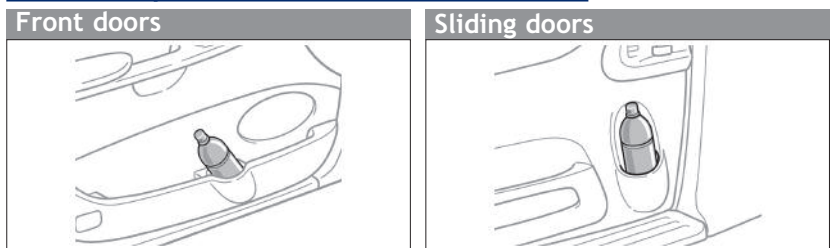

**Note:** Do not place open containers in the sliding door bottle holders.

**Cup holders**

**Instrument panel**

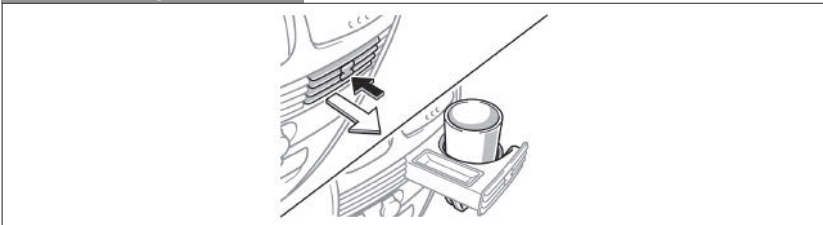

**Front side table**



**Third row area**

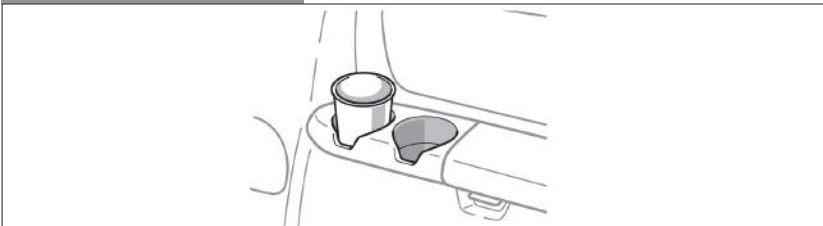

**Console box**

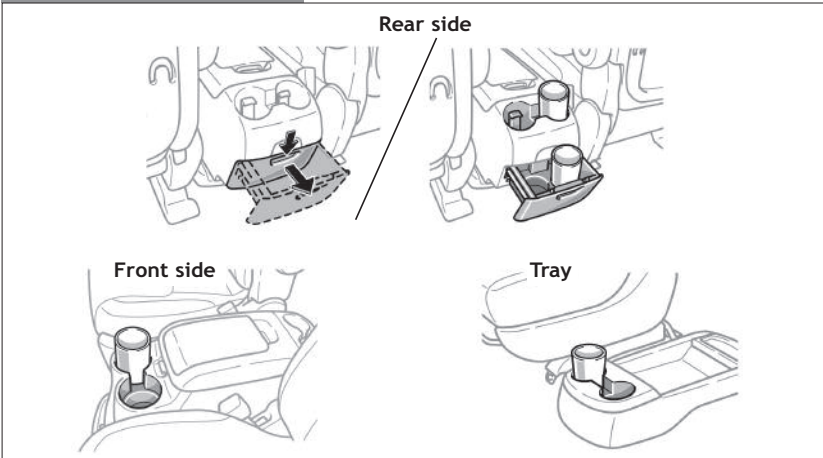

**Door locks**

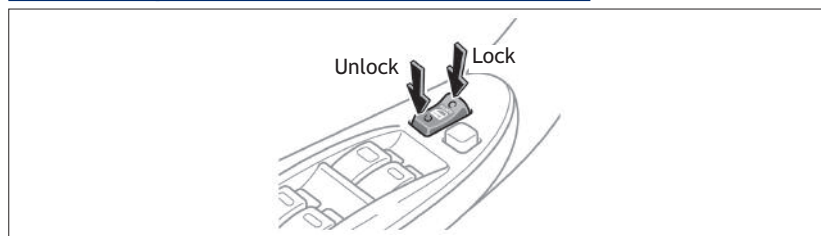

**Doors-Child safety locks**

**Rear door**

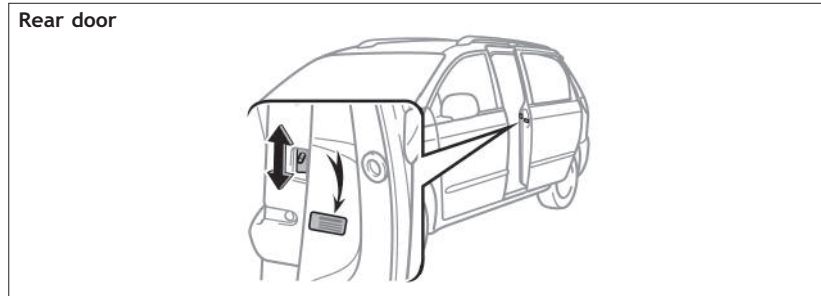

Moving the lever to "LOCK" will allow the door to be opened only from the outside.

**Seatbelts-Shoulder belt anchor**

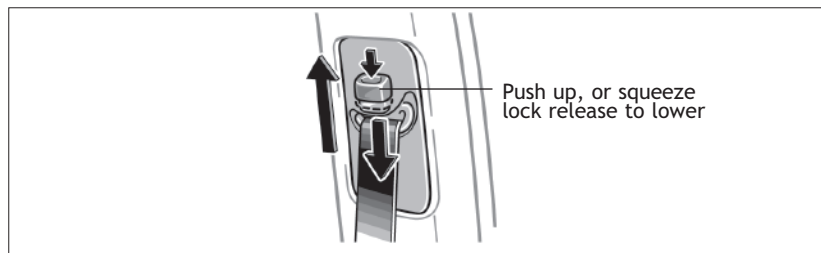

**Seatbelt comfort guide**

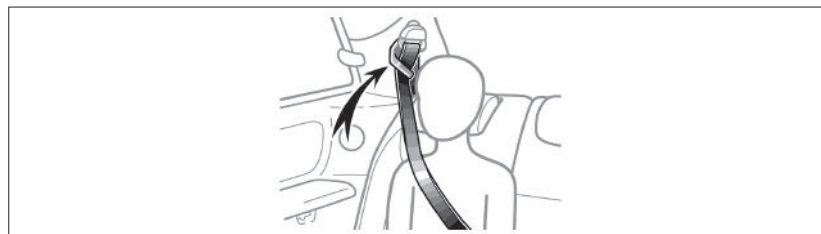

### Seatbelts

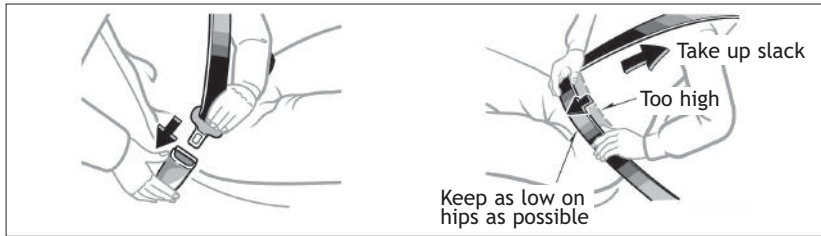

If belt is fully extended, then retracted even slightly, it cannot be re-extended beyond that point, unless fully retracted again. This feature is used to help hold child restraint systems securely.

To find more information about seatbelts, and how to install a child restraint system, refer to the *Owner's Manual*.

### Tire Pressure Monitoring (warning) System

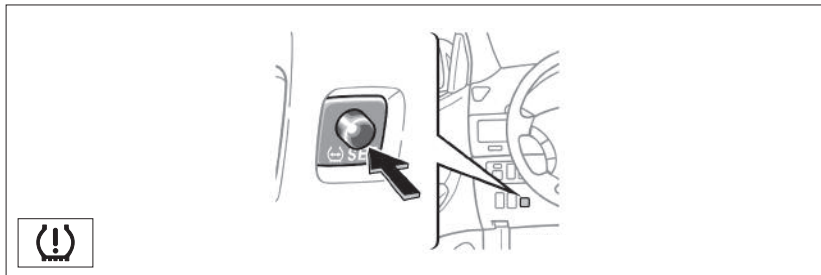

After adjusting tire pressures, or after tires have been rotated or replaced, turn the ignition switch to "ON" and press and hold the "SET" button until indicator blinks three times. Let the vehicle sit for a few minutes to allow initialization to complete.

Refer to the load label on the door jamb or the *Owner's Manual* for tire inflation specifications.

If the tire pressure indicator flashes for more than 60 seconds and then remains on, take the vehicle to your local Toyota dealer.

**Note:** The warning light may come on due to temperature changes or changes in tire pressure from natural air leakage. If the system has not been initialized recently, setting the tire pressures to factory specifications should turn off the light.

### Spare tire & tools

All-wheel drive models are equipped with run-flat tires. Refer to the *Owner's Manual* for more detail.

#### Tool and spare tire location

##### Two-wheel drive models

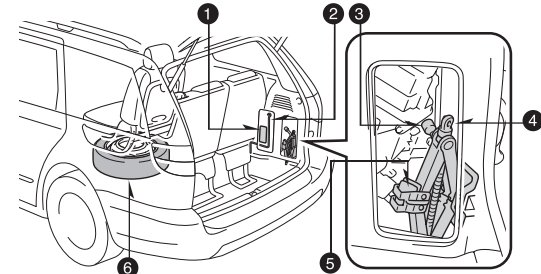

##### Four-wheel drive models

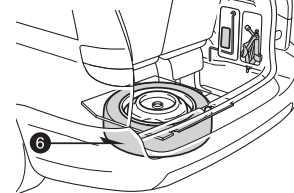

- 1 Tire bag
- 2 Jack handle
- 3 Wheel nut wrench
- 4 Jack
- 5 Adapter
- 6 Spare tire

#### Removing the spare tire

##### Two-wheel drive models

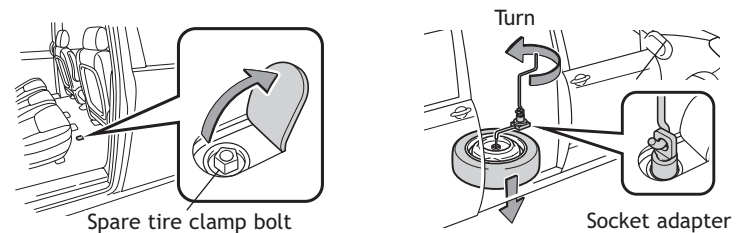

##### Four-wheel drive models

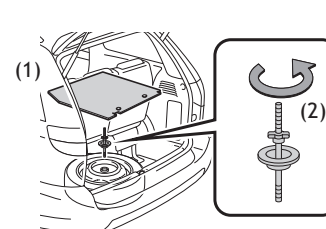

- (1) Remove the lid.
- (2) Loosen and remove the bolt.

Refer to the *Owner's Manual* for jack positioning and tire changing procedures.





CUSTOMER EXPERIENCE CENTER

1-800-331-4331

Printed in U.S.A. 4/09  
08-TCS-03079



**Mixed Sources**

Product group from well-managed  
forests, controlled sources and  
recycled wood or fiber

[www.fsc.org](http://www.fsc.org) Cert no. SGS-COC-005612  
© 1996 Forest Stewardship Council



00505-QRG10-SIE